

SERIES GSR1-4-V/VP

Stainless steel single-stage precision pressure regulator

FEATURES

- The GSR1 series is a successor model of the former GSN1 series, improving the basic performance.
- Two types are available: with stop valve(V) and with blow purge valve(VP)
- For He or H2, the 12-hour helium-filled test are conducted to confirm a high level of safety.

GSR1-4-V



GSR1-4-V

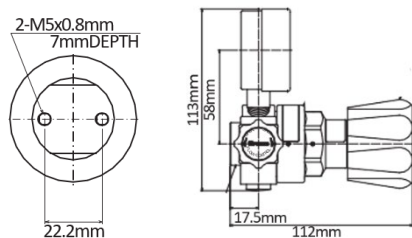

GSR1-4-VP



GSR1-4-VP

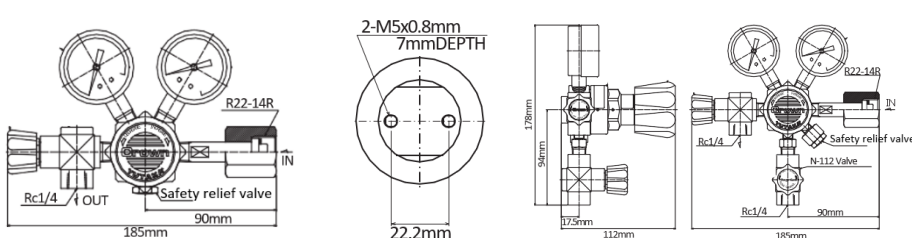

Body	SUS 316
Cover	C3771BE
Seat retainer	SUS316
Diaphragm	SUS316L + PTFE
Poppet seat	PCTFE
Safety valve seat	FKM

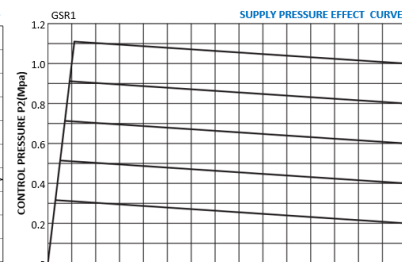
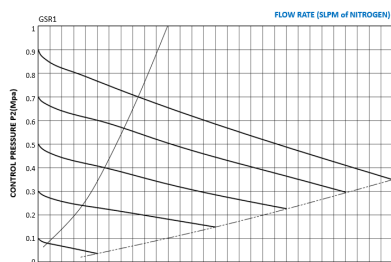

*Standard Specification Reference Chart.

INLET PRESSURE (Mpa)

	GSR1-4-5A□□-2RF4TF-V	GSR1-4-5A□□-□□□□□□-V	GSR1-4-5A□□□-2RF4TF-VP
Gas	N2 (Standard)	Ar, N2, Air, H2, He etc.	Ar, N2, Air, H2, He etc.
High pressure gauge	25Mpa	25Mpa	25Mpa
Low pressure gauge	0.6/1/1.6Mpa	0.6/1/1.6Mpa	0.6/1/1.6Mpa
Inlet pressure (P1)	~14.8Mpa	~14.8Mpa	~14.8Mpa
Delivery pressure (P2)	0~0.4/0.6/0.99Mpa	0~0.4/0.6/0.9Mpa	~14.8Mpa
Inlet connector	W22-14R	W22-14R etc.	W22-14R etc.
Outlet connector	Rc1/4	Rc1/4 etc.	Rc1/4 etc.
Option	--	--	Purge valve(Rc1/4)
Net weight	1.2kg	1.2kg	1.5kg

[NOTES]

- For part numbers other than those listed above, see page 57.
- Inlet pressure up to 20 MPa is a special option.

APPLICATION	Physics & chemistry
LOCATION	For cylinder
STANDARD FLOWRATE	50L/m

[OPTION]

- Outlet connector: Piping fitting ;Tube fitting
- Cleaning Grade

[DRAWING NOTES]

- Dimensions are subject to change without notice for improvement.

SERIES GF1 /GF2 /GSR1 /GSR2

Part Number Code

GF1·GF2 CODE

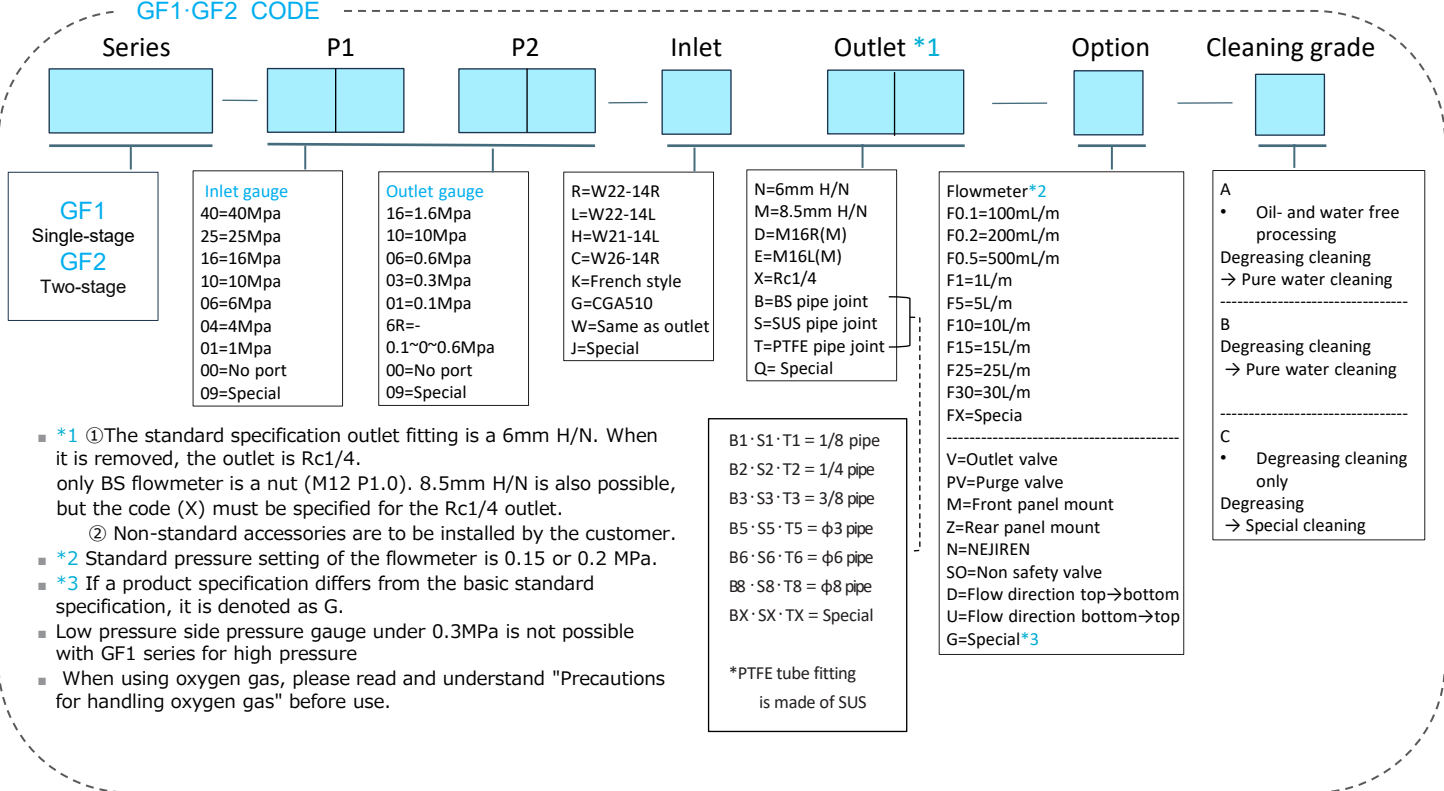

GSR1·GSR2 CODE

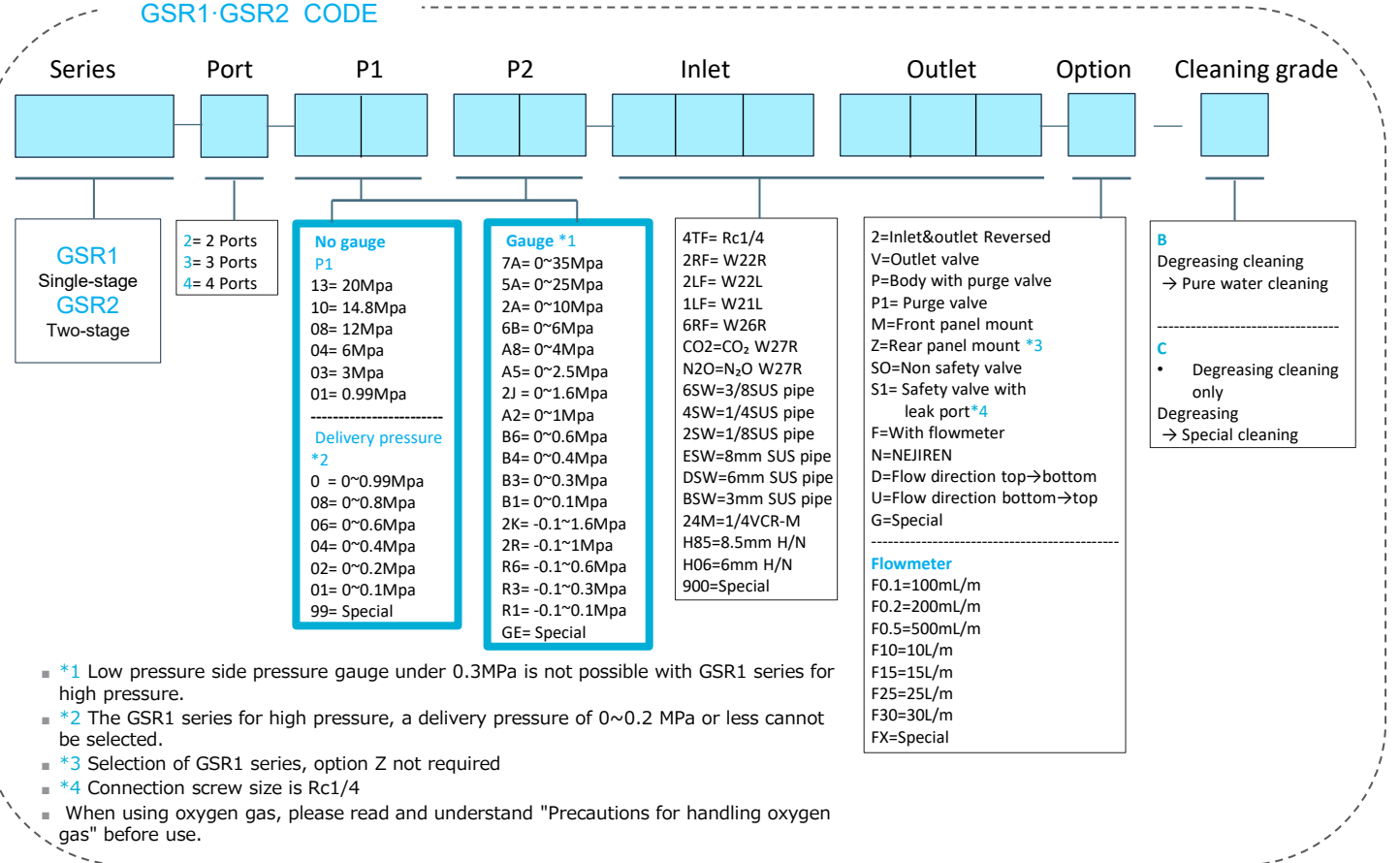

SELECTION

GENERAL INDUSTRIAL

PHYSICS & CHEMISTRY

MEDICAL

FLOW METER

EQUIPMENT

DATA